



DATA SHEET

50 Ω Lightning Arrester

Kabelwerk | **EUPEN** AG

DSL-Rev03/2006-10-10

cable

1/4 Wave Lightning Surge Arrester

The lightning arrester offers an additional protection for the BTS against lightning damages. EUPEN Quarter Wave protector can be used in wideband applications from 800 to 2500 MHz.

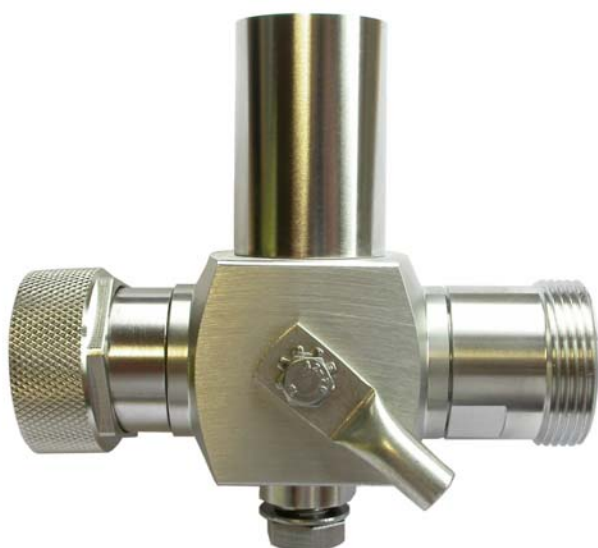

FEATURES

- *Quick and easy to install*
- *Basic range from 800 to 2500 MHz*
- *Tri-Band*
- *Arrester method: 1/4 Wave*

TECHNICAL DATA

Electrical specifications

• Nominal impedance [Ω]	50
• Frequency range [MHz]	800 - 2500
• Insertion loss (800 - 2500 MHz) [dB]	< 0.1
• Return Loss [VSWR]	
800 - 2500 MHz	< 1.15
880 - 960 MHz	< 1.07
1700 - 1900 MHz	< 1.07
1900 - 2200 MHz	< 1.07
• Surge current handling capability [kA]	20 kA (8/20 μs)
• Residual pulse energy [μJ]	≤ 0.5 μJ (3 kA @ 8/20 μs)
• Residual pulse voltage [V]	≤ ±3 V (3 kA @ 8/20 μs)
• Max. power [W]	300
• PIM ratio (2 x 25 W carrier) [dBc]	≤ -160

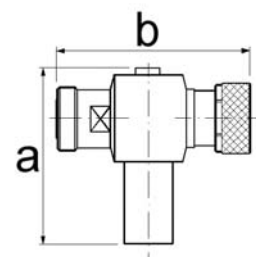

PRODUCT OVERVIEW

Product reference	Type	a [mm]	b [mm]	Part#
• EU-LA-QW-800-2500-DM-DF	7-16m - 7-16f	83.2	97.2	G652996

** Version -> 26.08.2006

